



PLKB
USER MANUAL

FOR LEADING EDGE INFLATABLE KITES

WELCOME

Thank you for buying this Peter Lynn product, and welcome to the World of Peter Lynn, a world of wind driven excitement, where people passionately pursue their dreams. Whether that's freeriding flat waters on your twintip or charging rolling sets on your directional. Peter Lynn is here to help you pursue your dream, making you achieve your ultimate challenge. Are you ready?

Peter Lynn has been there taking challenges from the early days of the sport. Challenges to develop breakthrough ideas, make better products, improve performance and quality in all aspects of those products. We have the right kites for all kite disciplines, for any terrain and for all conditions. All this is realized by a passionate crew of kite sports enthusiasts and we invite you to join us. It's that passion that makes us fly.

Before any attempt to use this product, please ensure you pay full and careful attention to the contents of this manual. While traction kiting is an exciting and fun sport, it can be highly dangerous, especially if not all the necessary safety precautions are taken. So please make sure you learn this great sport in a safe way. Only then will you progress quickly and enjoy this beautiful sport to the max.

Enjoy!

SAFETY INSTRUCTIONS

CAUTION: Kite powered sports can be very dangerous and physically demanding. The user of this product should understand that participating in kite powered sports may involve serious injury or death and agrees to observe the safety precautions listed below.

Safe location and weather conditions:

- Stay away from power lines, roads, airfields, railway lines, trees and buildings.
- Never launch your kite in crowded areas. Do not fly your kite over bystanders.
- Make sure there is a 'clear' downwind area at least three times the distance of your flying line length.
- Never fly kites or use this product in thunderstorms, lightning or gusty/stormy winds.
- Never fly a kite or use this product with wind forces so strong that you are unable to maintain full control of your kite and its power at all times.
- Do not fly a kite or use this product when wind conditions are likely to change dramatically.
- Stop kiting immediately when a storm or lightning is approaching.
- Make sure you are familiar with the location and local customs and laws before attempting any kind of kite sports.

Safe traction kiting:

- A traction kite is not a toy and should not be flown by inexperienced persons and certainly not by children.
- Learn to fly kites by starting in light winds with a small sized kite.
- Never use any type of kite or this product for paragliding, parachuting or base jumping.
- Never use any type of kite or this product for jumping off high places like hills or cliffs
- Never use any type of kite or this product for any manlifting activity.
- Always use fully protective gear when kiteboarding, landboarding, snowkiting or buggy riding.

Safe kiteboarding:

- Do not go kiteboarding in offshore winds.
- Be careful when kiting in onshore winds.
- We strongly recommend the use of helmet and life jacket/impact vest. A safety knife to cut flying lines in case of emergency is recommended.
- Do not kiteboard in spots already in use by swimmers or surfers.
- Beware of strong currents and sharks.
- Stay safely away from other watercrafts and shipping lanes.
- Never go further out to sea than you can safely swim back.
- Always make sure there is a capable person on shore that is keeping watch and is ready to provide (or call for) help in case of an emergency.
- We strongly recommend taking lessons from a certified kiteboarding school before using this kite on your own.

Safety issues when using this product:

- This kite has been manufactured with high quality materials and has been manufactured using the latest and most advanced production methods.
- Prior to every use of this product, fully check your equipment for any signs of wear and tear. Replace parts immediately where needed.
- Prior to every use of this product, check if your safety releases are still working properly and you are aware how to use it. In case the safety release does not work as it should, do not use this product and replace parts where needed.
- Only use this product for kiteboarding, buggy riding, landboarding and snowkiting.
- Do not use this product when your body weight is over 130kg (285lbs).
- Only use this product when you are in a good state of health. Never use this product when under the influence of alcohol, drugs or medication.
- Do not alter, modify or change this product. Repairs should be done by a professional kite repair shop, sail repair shop, or by the Peter Lynn company.

THE WIND WINDOW

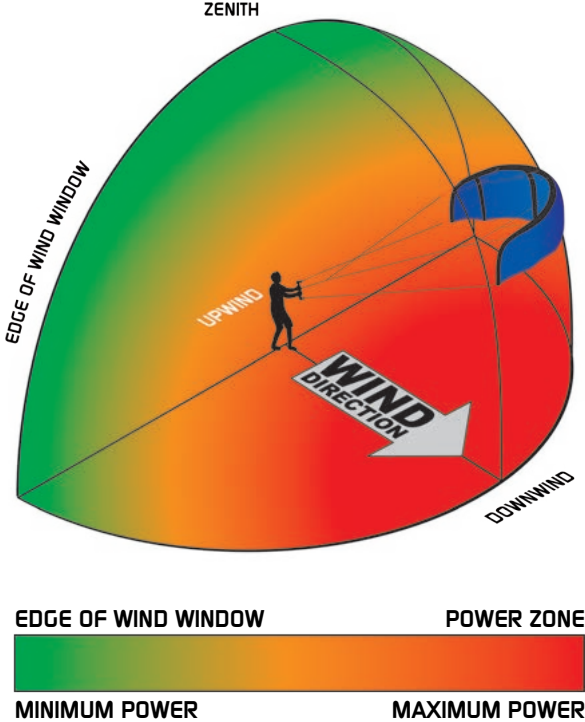

Before flying your kite it is very important to understand the 'wind window'. The image shows where the kite will create the most power (straight downwind, also known as the 'power zone') and where the kite will create the least power (edge of the window and zenith).

TERMINOLOGY

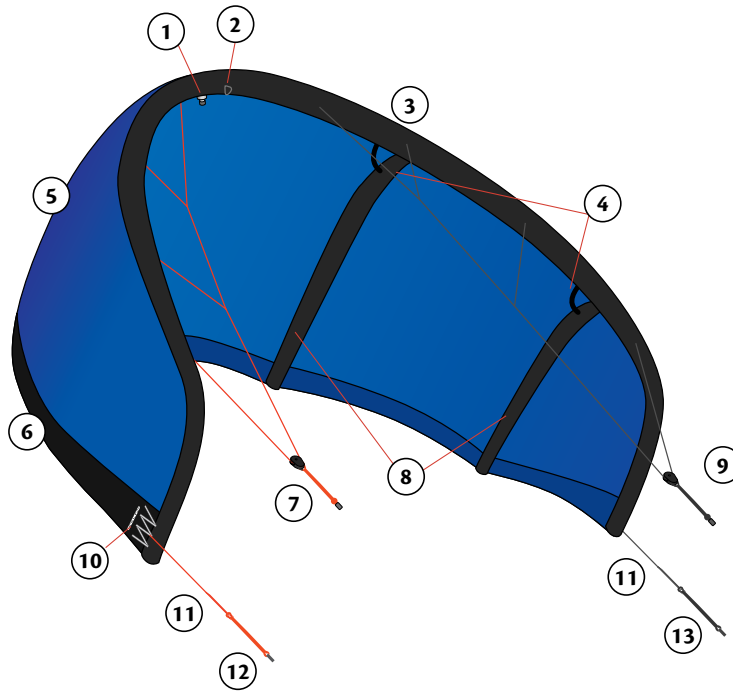

1. Inflate/deflate valve
2. Pump leash attachment
3. Leading edge
4. Single inflation air ducts
5. Canopy
6. Trailing edge
7. Left top line attachment point with low friction ring
8. Struts
9. Right top line attachment point with low friction ring
10. Bar pressure adjustment
11. Rear line adjustment
12. Left rear line attachment point
13. Right rear line attachment point

STARTING OFF

To start flying your kite you need to follow the following steps:

Step 1. Pumping up your kite

Step 2. Setting up your bar*, lines and preferred bar pressure setting

Step 3. Checking your safety systems*

*For more information on your controlbar please refer to the separate Navigator control bar manual

STEP I. PUMPING UP YOUR KITE

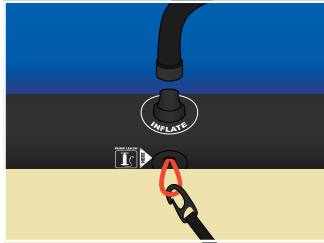

Place your kite on the ground with its leading edge into the wind, the bottom of the kite facing upwards. Attach the pump leash to the kite's pump leash attachment. Attach the pump hose to the valve.

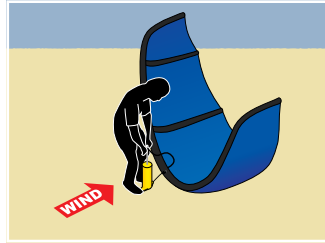

Make sure the clips on the air ducts leading to the struts are all open. Start pumping until the leading edge feels firm. If you prefer to use a pressure gauge, pump until it reaches about 6 psi.

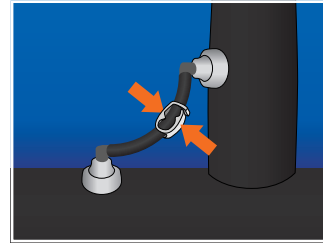

Detach the pump and close the inflate valve. Close the clips on the air ducts. This will prevent the whole kite from losing pressure in case of a puncture.

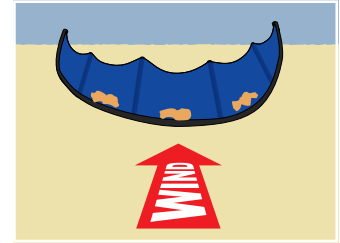

Place the kite on the ground with the top of the kite facing up, leading edge into the wind. Weigh down the canopy with some sand or a board with fins facing up.

STEP 2. SETTING UP YOUR BAR AND LINES

Attaching the top lines to the kite

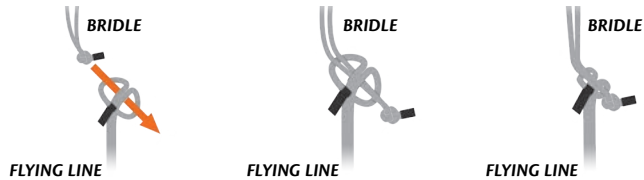

Make sure you attach your flying lines using a lark's head knot. Place a lark's head knot in the flying line connector, slide it over the middle knot on the top line attachment on the bridle and tighten the lark's head as shown.

Attaching the rear lines to the kite

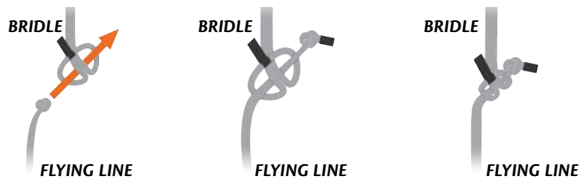

Connect the flying line connector to the rear line attachment and tighten the lark's head as shown.

Bar pressure

The rear line can be attached to 3 different positions to set the bar pressure.

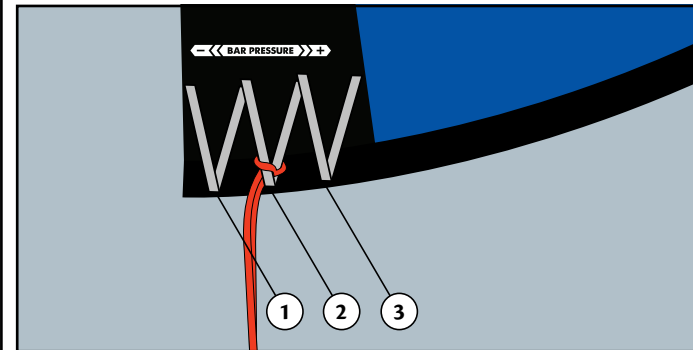

1. Minimum bar pressure
2. Medium bar pressure
3. Maximum bar pressure

Undo the bridle line from the webbing loops on the kite and re-attach the line to the correct webbing loop.

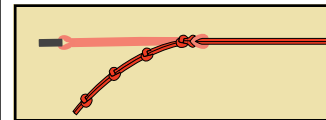

To shorten the rear lines attach the flying line attachment loop to the bridle line just behind the adjustment knot closest to the kite.

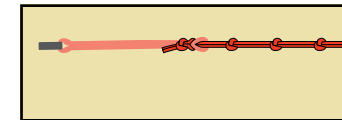

To make the rear lines longer attach the flying line attachment loop to the bridle line just behind the adjustment knot furthest away from the kite.

STEP 3. CHECKING YOUR SAFETY SYSTEMS

Before launching your kite always check if your primary and secondary safety releases function properly.

The Navigator control bar has a primary release on the depower loop. After activating the release, the kite is only supported by the safety line .

Activating the primary quick release

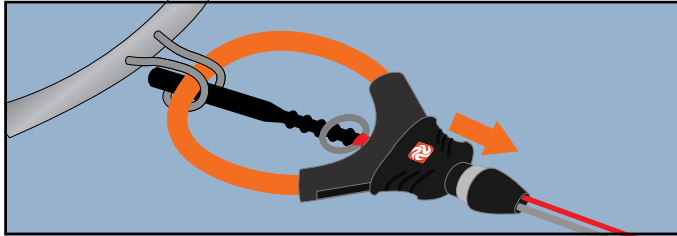

To activate your primary quick release, push the release cuff part towards the kite.

Re-connecting the primary safety release

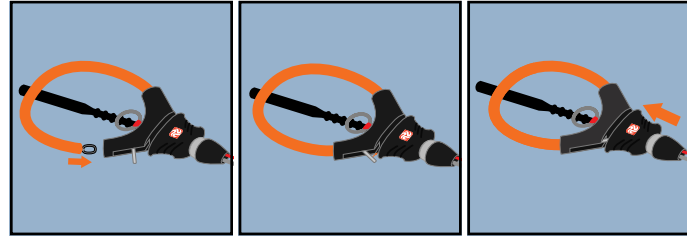

Re-connect the primary safety release by placing stainless steel ring on the end of the depower loop tube into the Centrix push-away center piece and behind the hook on the pin inside the center piece. Then push the pin into the center piece and lock it in place by sliding the release cuff back down. Always make sure all parts are free of sand and/or snow before re-connecting your safety system.

SECONDARY QUICK RELEASE

In case you completely want to disconnect yourself from the kite, you can activate the secondary quick release afterwards.

Activating the secondary quick release

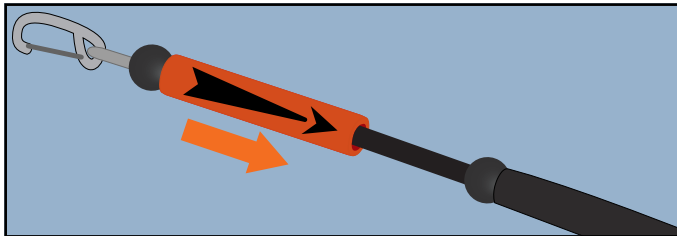

To activate your secondary quick release, move the red release in the direction of the arrows.

Re-connecting the secondary quick release

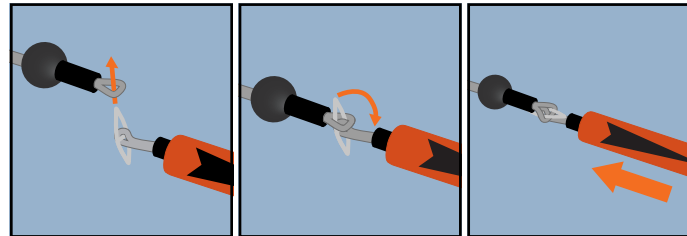

Re-connect the secondary safety release by placing the loop over the stainless steel pin, folding the pin down and sliding the release cuff back in place. Make sure the release cuff is sitting right against the ball after reconnecting.

CARE AND MAINTENANCE

Peter Lynn products are designed to be strong and durable. The extreme nature of the kite sport puts a high strain on the equipment involved. By taking good care of your equipment, you can minimize the wear on your equipment.

Kite care:

- Inspect your equipment before launch. Check for tears, abrasions, undone stitching, and all other forms of damage.
- Test all moving parts of your equipment such as pulleys before every launch.
- Do not rig on rough terrain. Stay far away from sharp items that could damage your kite, such as seashells, trees, washed up wood or fences.
- Secure your kite using soft items like sand or sand bags. Do not use items with sharp edges like rocks.
- Do not unnecessarily leave a kite unused for a longer period of time to prevent UV damage. Weigh down fluttering parts to reduce wear.
- Before connecting your pump to the inflate valve, pump it a few times to remove any sand from the hose.
- Always make sure your kite is dry before packing and free of sand or sharp items.
- Regularly rinse your kite when used in salt water.
- When storing for a long time, it is advised to leave part of the bag open, to allow fresh air to get in the bag, and any remaining traces of moist to dry up.

Bar care:

- Make sure you regularly check your bar for wear and tear. Replace parts when needed.
- Make sure your flying lines are free of knots.
- Before launching, always check that your quick releases are in working order and free of sand or other debris.
- When reaching the water, before starting your kiteboarding session, splash some water on your bar to rinse off sand that has stuck to it.
- After every session, rinse your bar with tap water to remove the salt from the bar.

If there are problems with your kite or your bar, please contact your Peter Lynn dealer.

WARRANTY

Peter Lynn warrants this product, when it is purchased from an authorized Peter Lynn dealer by a retail customer, to be free of major defects in material or workmanship to the original purchaser, for a period of six (6) months from the date of purchase by the original retail customer. This warranty is subject to the following limitations:

- The warranty is solely for the benefit of the original retail purchaser and may not be assigned. For retail customer warranty claims, proof of purchase from an authorized Peter Lynn dealer is required. If the date of purchase can not be established, Peter Lynn will make a determination based on the last production year and/or the condition of the particular product claimed.
- The warranty on this product is valid only when it is solely used for designated purposes c.q. kiteboarding on water and does not apply to any product used for rental and/or teaching purposes.
- Peter Lynn will make the final warranty determination, which may require inspection and/or photos of the equipment. Photos must clearly show the defect(s). If necessary, this information must be sent to the Peter Lynn dealer where the product was originally purchased, postage prepaid. Alternatively you may contact the Peter Lynn distributor in (or nearest to) your country.
- If a product is deemed to be defective by Peter Lynn, the warranty covers the repair or replacement of the defective product only. Peter Lynn will not be responsible for any costs, losses, or damages incurred as a result of loss of use of this product. This warranty does not cover damage caused by misuse, abuse, neglect or normal wear and tear including, but not limited to, damage due to excessive sun exposure, use in combination with other than Peter Lynn control gear, damage caused by improper handling and storage, damage caused by use in waves or shore break, and damage caused by anything other than defects in material and workmanship.
- The warranty is voided if any unauthorized repair, change or modification has been made to any part of the equipment. The warranty for any repaired or replaced equipment takes effect from the date of the original purchase only. The original purchase receipt must accompany all warranty claims. The name of the Peter Lynn dealer and the date of purchase must be clear and legible.
- There are no warranties which extend beyond the warranty specified herein.

Warranty Claims

Warranty claims must be processed through an authorized Peter Lynn dealer and be issued a return authorization prior to shipping the product concerned. For claims processing please contact the Peter Lynn dealer the product was purchased from or call - or write to - the national Peter Lynn distributor. If there is no Peter Lynn distributor in your country, please find our contact details on our website www.peterlynn.com.

DISCLAIMER – RELEASE OF LIABILITY

Peter Lynn / Vliegerop Ltd - Release of Liability

Caution

Before making any attempt to set up or use this product, you agree to have read and fully understood the entire Peter Lynn LEI user manual; including, but not limited to, all instructions and warnings it contains. You also agree to make sure that any other user of this Peter Lynn product, prior to using it, will also read and fully understand this Peter Lynn LEI user manual; including, but not limited to, all instructions and warnings it contains.

Assumption and acceptance of risk

Kite powered sports can be very dangerous and physically demanding. While powerkiting in its many forms is an exciting and fun sport, it can be highly dangerous for yourself and others around you, especially if the necessary safety precautions are not or only partly taken. The user of this Peter Lynn product should understand that participating in kite powered sports can result in serious personal injury – and even death – to the user as well as to third parties. Before setting up and using this Peter Lynn product you agree to assume and accept any risk of injury, whether known or unknown, to both yourself and any third parties from using this Peter Lynn product. To reduce these risks, we strongly recommend you to stick to the safety precautions listed in this Peter Lynn user manual.

Disclaimer and Release of Liability

Concerning the purchase of this Peter Lynn product by you, you hereby agree, to the greatest extent allowed by law, to waive any claims you have or may have in the future against Peter Lynn and all related entities resulting from using this Peter Lynn product and/or any of its components.

You will also release Peter Lynn and all related entities from any liability for special, indirect, incidental, consequential or exemplary damages, whether in contract, tort, negligence, strict liability or otherwise including, but not limited to, loss of property other than this Peter Lynn product, loss of use of this product, or other property or other economic losses. Peter Lynn shall not be liable for contribution or indemnification, whatever the cause.

All terms and conditions contained herein shall, in the event of your death or incapacity, apply and be binding upon your heirs, next of kin and any other representatives including, but not limited to, administrators and executors. The foregoing provisions regarding liability and warranty are exclusive and in lieu of all other liability- and warranty statements, whether written, oral or implied.



PLKB

Never stop playing!

PETERLYNNKITEBOARDING.COM